

PLEASE ENSURE THE DRAWING MATCHES YOUR REQUIREMENTS OR DRAWINGS. NO RESPONSIBILITY IS ACCEPTED FOR CHECKING OTHER DRAWINGS AND SUBSEQUENT CHANGES ONCE MANUFACTURE COMMENCES WILL BE SUBJECT TO ADDITIONAL COSTS.

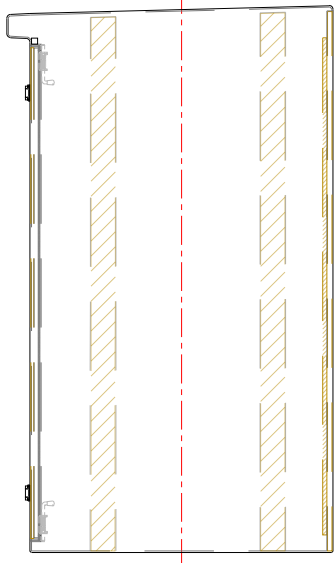
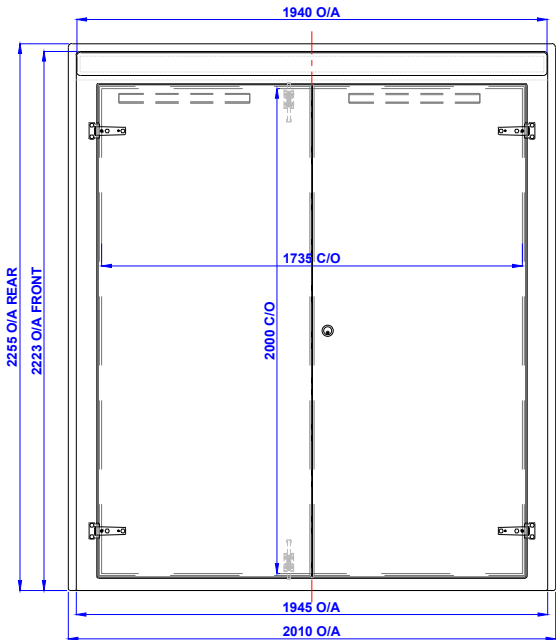
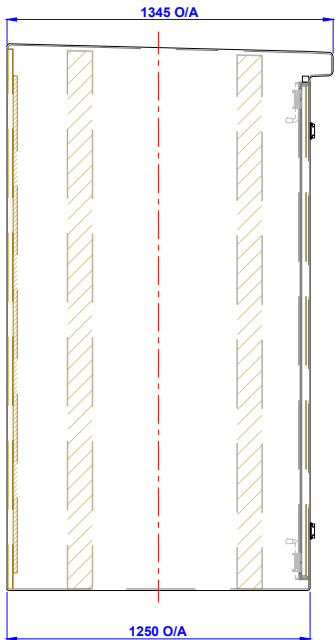
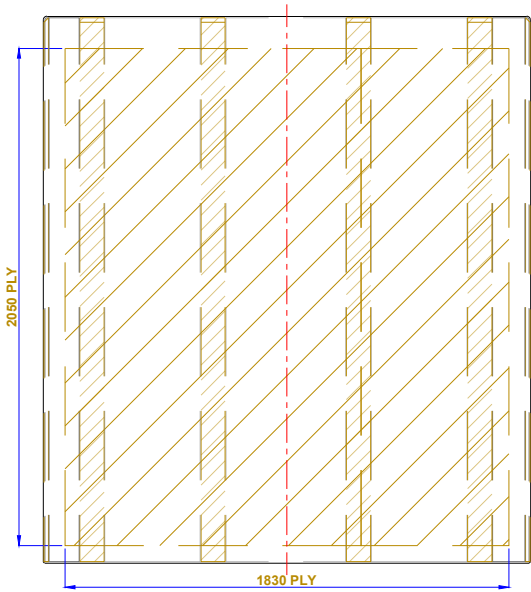
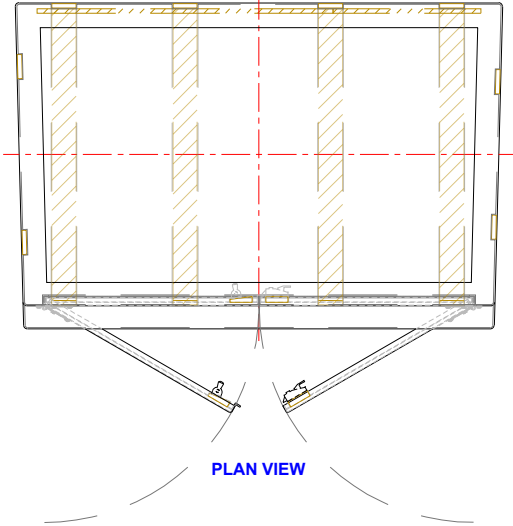

NOTE: PERIMETER OF ENCLOSURE, OR STEEL BASE, MUST BE FULLY SUPPORTED ALONG ITS ENTIRE LENGTH AND WIDTH

FINISH AND COLOUR				
	EXTERNAL	INTERNAL	ROOF	DOOR(S)
FINISH COLOUR REF. CODE	SEMI GLOSS SEE JOB CARD	MATT WHITE	SEMI GLOSS SEE JOB CARD	SEMI GLOSS SEE JOB CARD

PARTS LIST

ASSEMBLY PARTS	ITEM	DESCRIPTION	SOURCE	QTY.	COMMENTS
	PANELS	ENCLOSURE CONSTRUCTION		1	
	A	DOUBLE DOOR C/W....	LAM	1	SEE DRAWING FOR SIZE
		HINGES - ST-STEEL	STORES	4	
		DOOR LOCK	STORES	1	
		SPRING TOWER BOLT - STANDARD	STORES	2	
		DOOR STAYS- STANDARD	STORES	2	
	B	TREATED PLY BOARD	LAM	1	SEE DRAWING FOR SIZE

MANUFACTURING INFORMATION

WALLS: GRP/STRUCTURAL MEMBERS/GRP

ROOF: GPR

BUILD TYPE: READY BUILT

BASE FLANGE: 100mm FLANGE

TOTAL KIOSK WEIGHT (EXC. EQUIPMENT): 290 Kg

OTHER INFO:

STEPPED CONCRETE BASE : RECOMMENDED.

Morgan Marine Ltd Cannot be held responsible for sealing on a flat plinth. (Max Deviation Allowable +/- 5mm) Any failure in the seal, resulting in subsequent site visits would be chargeable. The step will affect clear internal height, ie a 50mm step will reduce the clear internal height quoted by 50mm. Gaps between the concrete base and GRP base flange - In Excess of 10mm Will NOT be sealed by MML.

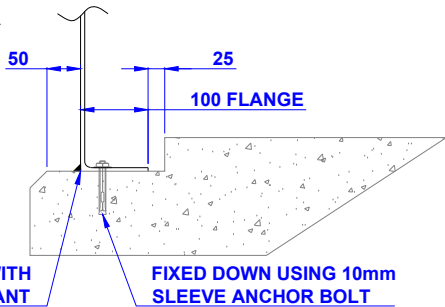

REV.	DATE	DESCRIPTION	BY
E	18/06/25	FOR INFORMATION	C.J

REVISION HISTORY

REF	DRAWN	DATE	DRAWING NUMBER
-	D DAVIES	11/12/2024	A3 TYPE F CC

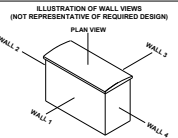

THE DRAWING AND DESIGN IS THE PROPERTY OF MORGAN MARINE LTD. AND WITHOUT THE WRITTEN CONSENT OF MORGAN MARINE LTD.MAY NOT BE COPIED IN WHOLE OR IN PART OR COMMUNICATED TO A THIRD PARTY OR USED FOR ANY PURPOSE.



GENERAL TOLERANCE

OVERALL +/- 5mm

DIMENSIONS IN mm

NOT TO SCALE

AutoCAD
2012 LT.

CLIENT

MORGAN MARINE LTD

SCHEME

TYPE F